



KBM[®]-15

HAND HELD PLATE MILLING BEVELLING MACHINE

Adjustable bevel angles
from 15° through 60°
Compact and Lightweight
Micrometric bevel depth
adjustment.



PARTS LIST & OPERATING INSTRUCTIONS

Website: www.gullco.com

Distributed by:

GULLCO INTERNATIONAL LIMITED – CANADA

Phone: 905-953-4140 Fax: 905-953-4138 e-mail: sales@gullco.com

GULLCO INTERNATIONAL INC. – U.S.A.

Phone: 440-439-8333 Fax: 440-439-3634 e-mail: ussales@gullco.com

GULLCO INTERNATIONAL [U.K.] LIMITED - EUROPE

Phone: +44 1257-253579 Fax: +44 1257-254629 e-mail: sales@gullco.co.uk

GULLCO INTERNATIONAL PTY LIMITED - AUSTRALIA

Phone: 61 (0) 7 5439-0701 Fax: 61 (0) 7 5439-0704 e-mail: ausales@gullco.com

GULLCO INTERNATIONAL INDIA PRIVATE LIMITED – INDIA

Phone: 91-20-65260382 Fax: 91-20-26836656 e-mail: indsales@gullco.com

GULLCO INTERNATIONAL SHANGHAI – LIMITED

Phone: +8621-50460341 Fax: +8621-50463554 e-mail: gsuntech@sh163.net

KBM®-15 HAND HELD PLATE BEVELLING MACHINE

TECHNICAL DATA

- Guides length: 200 mm
- Motor type: 1 phase – 230 Volts - 0.95 kw – 2900 r.p.m.
1 phase – 115 Volts - 0.95 kw – 2900 r.p.m.
- Three (3) milling cutters, diameter 60 each with five (5) inserts installed.
- Chamfering control: - 0 to 15 mm in just one pass.
- Tilting table from 15" up to 45".
- Weight: 13 kilograms
- Equipped with square-shaped tungsten carbide inserts – 12.7 x 12.7 x 3.18 ISO 1203 SPUN
- It can use the inserts having worn edges and if the same have already been used on milling machines.
- UTILIZATION RANGES:
The machine is used to carry out chamfering operations on any kind of ferrous material, in particular steel and cast iron. As regards to other materials, such as aluminum and plastic, we recommend model L, equipped with milling cutter working with 18 super-positive inserts.



SAFETY WARNINGS

- Before carrying out any maintenance jobs, take care to disconnect the machine from the power supply mains.
- Remove the work guides just after you have electrically disconnected the machine
- When machining is being carried out, wear eye protectors provided with anti-shock lenses in order to avoid that iron splinters and chips may damage your eyes.
- When machining is being carried out, use the handles provided to hold tight the machine with both hands.
- The results obtained after the machine has been tested to check its noise level (85 – 90), lead us to suggest you protect your ears properly.
- **IMPORTANT: Do not use this chamfering machine for wood.**
Use in wet places or narrow conductors is forbidden.

The logo for GULLCO, featuring the word "GULLCO" in a bold, black, sans-serif font. The text is centered between two horizontal orange bars of equal length.

KBM[®]-15 HAND HELD PLATE BEVELLING MACHINE

INSTRUCTIONS FOR USE

- **UNPACKING OPERATORS:** Special care is required when you unpack the machine. Avoid making any manoeuvre which might somehow damage it. When the machine is duly unpacked, check that all its parts are in perfect condition. If any anomalous condition is ascertained, do not use the machine and contact your Seller.
- **PACKING CONTENTS:** Machine ready for use, instruction manual, and wrenches.
- **INSTALLATION:** The machine is equipped with power supply cable 1P+N+ \perp with cross section area = 1.5 mm. Before connecting to the power supply mains, connect the power supply cable to an industrial plug; the plug must be in compliance with CEI EN 60309-1 Standards, 1P + N + \perp , 400 Volts, 16Amp, Protection Class IP 44, at least. Please refer to the electrical diagram for the lead distinctive colours.
- Before connecting the machine to the power supply mains, make sure that: the line has a suitable square section for the current absorbed by the machine and that the proper protection device to prevent overloads is duly installed above it.
- The earthing system and the current supply cut-out switch located above the machine must be set in such a way that the very best protection is assured against indirect contacts at all times, according to CEI 64-8 Standards. Make sure that this protection is duly assured by an adequate high-sensitivity differential device (30 mA).
- The power supply line, on the spot where the machine is installed, shall have to be duly protected against short-circuit currents.
- **CHAMFERING WIDTH CONTROL:** In order to control the chamfering width, loosen the hand-wheel C and turn the hand-wheel D according to need; then lock again the hand-wheel C.
- **UTILIZATION:** Make sure that the milling cutter rotates in the right directions. Place the machine on the piece to be chamfered, move the isolating switch to the ON position; use the handles provided to hold tight the machine with both hands and exercise a slight pressure on the piece; then move the machine towards the right direction for the machining. **NOTE:** When the machine is working, the hand-wheel C must always be kept in its locked position.
- **STOPPING OPERATION:** To stop the machine, move the isolating switch to the OFF position.
- **REPLACEMENT OF INSERTS:** Before replacing the inserts, make sure that the machine is off. Disassemble the two guides A and B; by removing the fasteners, loosen the inserts security dowels. After a thorough cleaning install the new inserts by tightening gently the security dowels. Only at the end tighten all screws.



KBM[®]-15 HAND HELD PLATE BEVELLING MACHINE

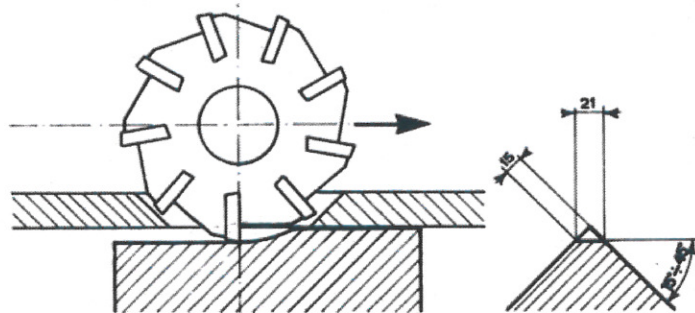

GULLCO

**KBM[®]-15
HAND HELD PLATE
BEVELLING MACHINE**

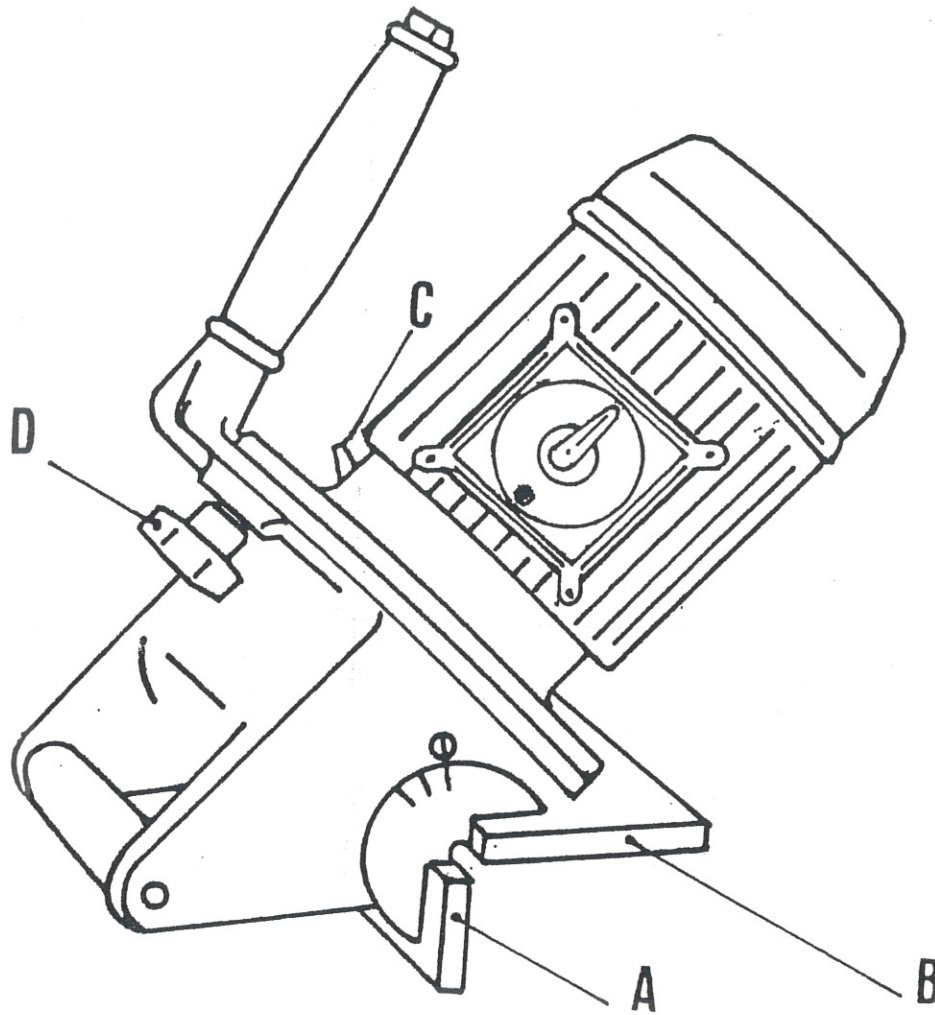

1 2 3 4 5 6 7 8 9 10 11 12 13 14

R-L1
115 VAC 60HZ

BLACK

BLUE

N-0

PE

STOP

START

E

3KM1

115V.

0.9KW

60mF



GULLCO INTERNATIONAL LIMITED
1175 NICHOLSON ROAD · NEWMARKET ·
ONTARIO · CANADA · L3Y 9C3

KBM-15
HAND HELD
PLATE BEVELLING
MACHINE

DATA 15-06-2010

KBM-15

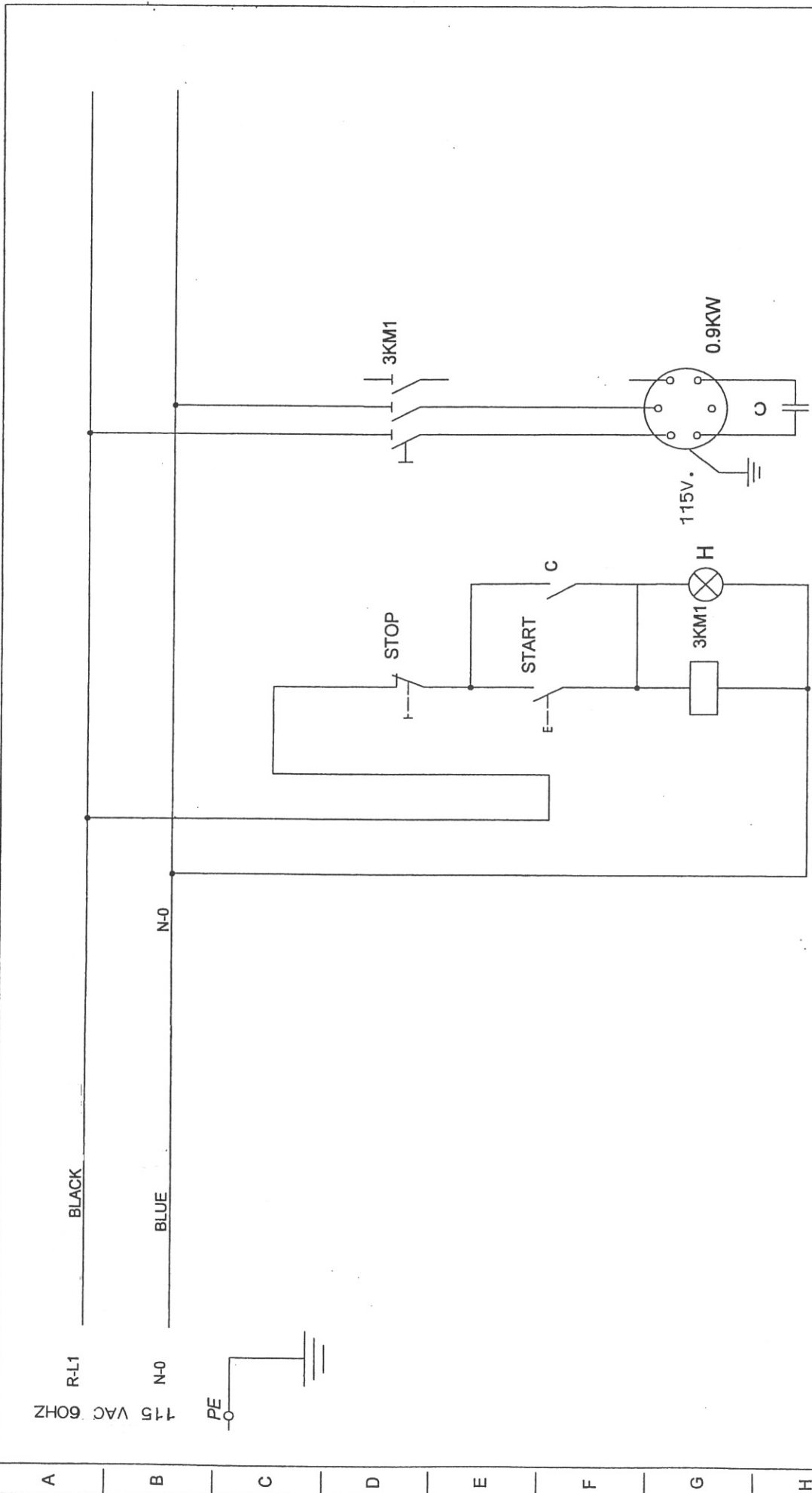

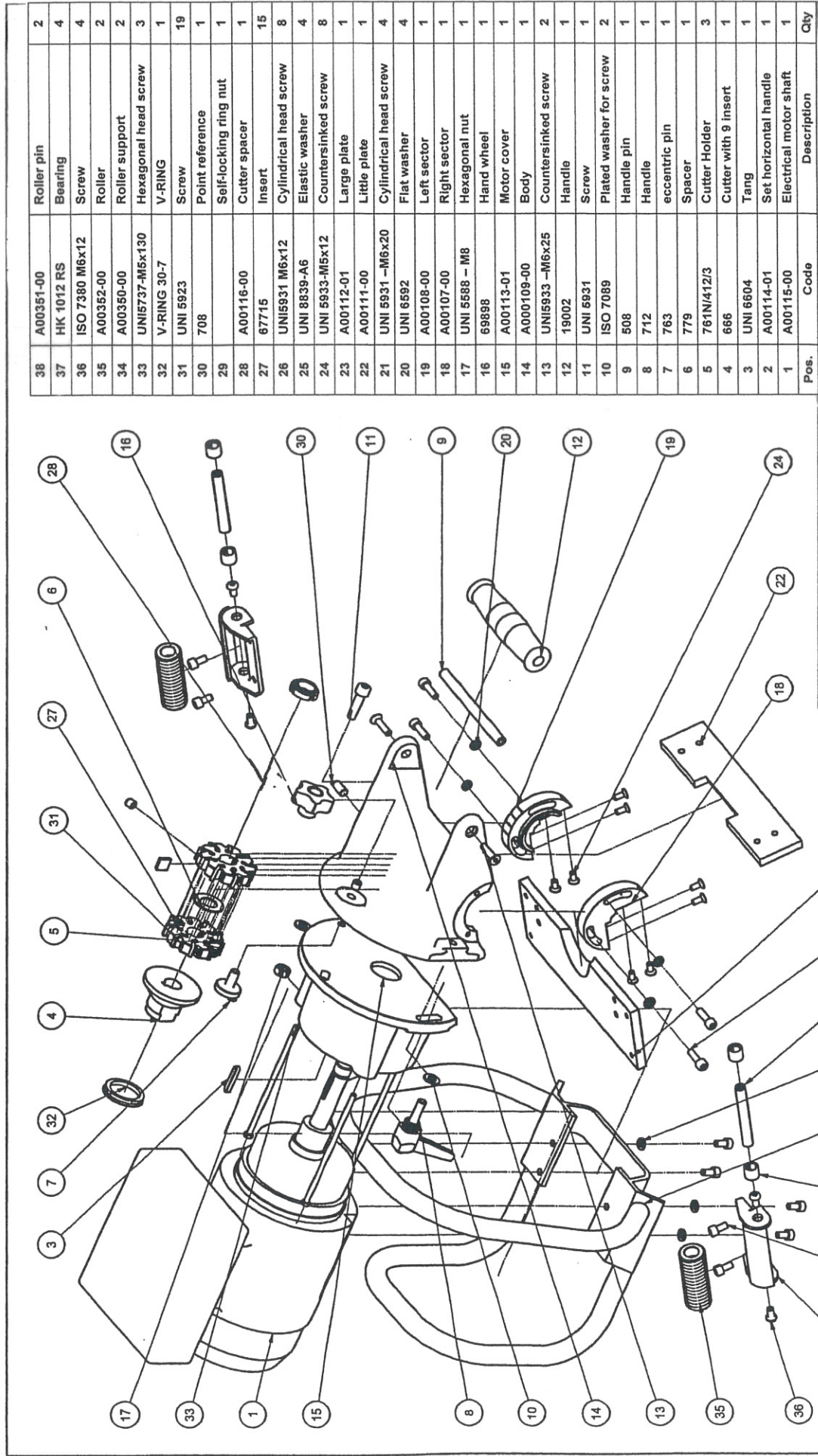

Pos.	Code	Description	Qty
38	A00351-00	Roller pin	2
37	HK 1012 RS	Bearing	4
36	ISO 7380 M6x12	Screw	4
35	A00352-00	Roller	2
34	A00350-00	Roller support	2
33	UNI5737-M5x130	Hexagonal head screw	3
32	V-RING 30-7	V-RING	1
31	UNI 5923	Screw	19
30	708	Point reference	1
29		Self-locking ring nut	1
28	A00116-00	Cutter spacer	1
27	87715	Insert	15
26	UNI5931 M6x12	Cylindrical head screw	8
25	UNI 8839-A6	Elastic washer	4
24	UNI 5933-M5x12	Countersunk screw	8
23	A00112-01	Large plate	1
22	A00111-00	Little plate	1
21	UNI 5931 -M6x20	Cylindrical head screw	4
20	UNI 6592	Flat washer	4
19	A00108-00	Left sector	1
18	A00107-00	Right sector	1
17	UNI 5588 - M8	Hexagonal nut	1
16	69898	Hand wheel	1
15	A00113-01	Motor cover	1
14	A000109-00	Body	1
13	UNI5933 -M6x25	Countersunk screw	2
12	19002	Handle	1
11	UNI 5931	Screw	1
10	ISO 7089	Plated washer for screw	2
9	508	Handle pin	1
8	712	Handle	1
7	763	eccentric pin	1
6	779	Spacer	1
5	761N/412/3	Cutter Holder	3
4	666	Cutter with 9 insert	1
3	UNI 6604	Tang	1
2	A00114-01	Set horizontal handle	1
1	A00115-00	Electrical motor shaft	1

Indice	Descrizione modifica		Data	Firma
				Romolo Folio
Codice GREZZO/MODELLO	SM 0.5	R		A3
Materiale	Dimensioni	Treat. superfic.	Treatmento termico	Carat. trat. term.
				Peso finito
				N/A
GULLCO		KBM-15 HAND-HELD PLATE BEVELLING MACHINE		N° Tav.
Scale	Data	Disegnatore	Approv.	N° Dia.
	07/06/2010	C. V.	C. V.	E00001-02
				1/1